

Directions for Printing Instruction Manual

The instruction manual is located below – just scroll down to read it.

To print, follow these steps:

1. We recommend printing on legal size paper if you have it. You can also use ordinary letter paper. Indicate your paper size by clicking on “Properties.”
2. Set “Page Scaling” to “Fit to paper”.

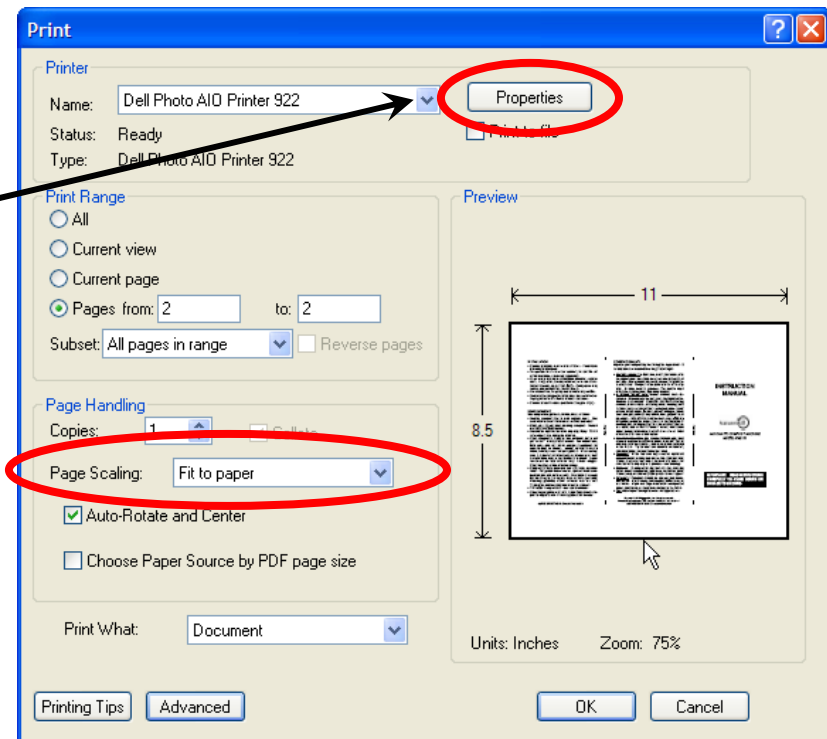

INSTALLATION

- The air pump may initially make a humming sound. This is normal. It will become *nearly silent* after several days, as the unit fills and warms up.
- Choose a convenient location indoors or outdoors. Warmer is generally better, up to 120F (50C).
- For outdoor use, protect from rain and do not freeze.
- Unpack the power cord and other items from inside the unit (open the side door). Plug the power cord into the back of the unit. Never unplug for 1 hour or more – composting may cease.
- **To operate in a closet or cabinet only:** install the air extension tube, enclosed separately.

CLEANING & MAINTENANCE

- DO NOT clean the inner reactor. Never use soaps, sprays, or chemicals. These can destroy cultures.
- With a damp paper towel only, wipe exterior surfaces, lip area, and cure tray area, as needed.
- Rinse the trays with a hose when you empty them.
- Clean any loose compost from the cure tray area.
- Clean any debris from lid and side door seals.
- Replace the air filter every 1–2 years, if odors develop. See www.naturemill.com.
- Optional: add more soil periodically to the reactor. This ensures vigorous compost reactions.
- The wait light may come on for up to 48 hours. To override the wait, hold the OK button for 5 seconds.

CLEARING A JAM

In the rare event that the JAM light comes on:

1. If the reactor is full all the way up to the lid, remove some material until it is only half full.
2. Wait 24 hours and then push the OK button. This may clear the jam (material softens up with time).
3. If the jam light comes on again, locate and remove the jammed item in the reactor. **Often it is string, a hard item, or a thick wad of paper.**
4. Press the OK button to resume normal operation.
5. In the future, avoid whatever jammed. Add smaller, softer items. Paper should be shredded and spread out across the width of the reactor, not clumped up.

visit www.naturemill.com for more information

IMPROVING COMPOST QUALITY

Compost takes time - and practice! Healthy compost is dark, spongy, moist, and warm, with a mild organic “earthy” aroma of damp wool, mushrooms, parmesan cheese, or coffee. Steam and heat rising from the compost are good signs. Here are some tips:

- **Leave compost in the machine** as long as possible, in both the reactor stage and cure tray stage. Ideally, allow 7-14 days between cycles.
- **Add extra “brown” items:** shredded paper, sawdust, bread, rice, etc. Add at start of each cycle, and keep adding. These fuel compost reactions. Food alone may produce wet, sour smelling compost.
- **Cut items smaller,** especially items visible in the final compost. Avoid items that do not break down.
- **Curing** will improve overall compost quality. See “Gardening with Compost.”
- **Wetness:** If compost is wet (especially at the bottom) or the white drip tray is overflowing: position the white drip tray as per drawing. Add less fruit, lettuce, or other wet items. Add more dry, brown items like shredded paper, sawdust, bread, rice, etc. Wetness may result in surface mold, which is harmless.
- **Dryness:** If compost is dried out or crunchy, with dry areas poorly composted, in the future add more wet items (fruit, lettuce, etc.), or add 2 oz (60 ml) water.
- **Texture:** Compost should be spongy and loose, like mulch. If it is very hard and chunky or you recognize individual items, add smaller, softer items in the future. If runny or powdery, add larger pieces. For uncomposted items, avoid or chop smaller in the future.
- **A strong odor** means cultures may be dormant. Compost may be light brown, cool, and wet. **SOLUTION:** add more “brown” items and wait 24 hours. Be sure the air pump is humming at all times, with air flowing in via the carbon filter and out via the exhaust. If odors persist, press the OK button to cycle, then add two cups (500 ml) healthy soil to reactor; increase brown items (shredded paper, sawdust, bread, pasta, rice, etc); limit acidic or wet items; add 1/4 teaspoon baking soda when adding food; review all instructions. Odor should cease in 24-48 hours.

visit www.naturemill.com for more information

INSTRUCTION MANUAL



**AUTOMATIC COMPOST MACHINE
MODEL NM5125**

**IMPORTANT: READ INSTRUCTIONS
CAREFULLY FOR BEST RESULTS.**

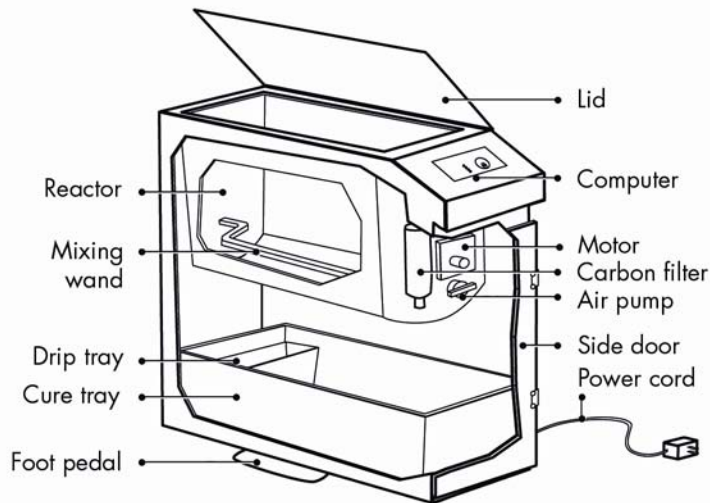

PRECAUTIONS



- Handle compost as you would soil: wash hands after contact; wash garden vegetables before eating; keep compost away from food or dishes.
- Supervise children and pets near fresh compost.
- Cut waste items into 1 TO 3 INCH (3-8 CM) PIECES to aid in decomposition. Smaller pieces are better.
- DO NOT unplug the machine for longer than one hour at a time, or composting may decrease.
- Close lid & side door tightly. Clear debris from seals.
- DO NOT clean the reactor. Never use soap or chemicals. This destroys compost cultures.
- A strong “trash truck” odor means cultures may have been destroyed. See COMPOST QUALITY.
- Fresh compost is very powerful so apply to soil surface only, at the recommended quantity. See GARDENING WITH COMPOST section.
- Read instructions thoroughly. Check naturemill.com periodically for updates.

WARRANTY AND CUSTOMER SERVICE

Visit www.naturemill.com for customer service & warranty information. Due to sanitation reasons, unit generally can not be returned after exposure to food waste.

visit www.naturemill.com for more information

STEP 1: ACTIVATE THE COMPOST

1. Insert trays into machine with the white drip tray at the far end, away from the side door. See drawing.
2. **“Activate” compost by placing 2 cups (500 ml) of soil into the reactor. This is needed only once.** Use natural outdoor top soil, where plants or weeds grow. Cold, frozen, wet, dry, sandy, or clay soil is ok.
3. Plug in the power cord at all times. The air pump will hum and the mixer will snap occasionally – *they will grow nearly silent as the unit fills and warms up.*

STEP 2: ADDING WASTE ITEMS

Add waste items at any time, as per reference list. The mixing wand turns automatically for a few minutes, several times per day. Material gradually darkens, heats up, and shrinks in volume, and turns into compost. Follow these tips for best results:

- Add two handfuls of “brown” items at the start of each cycle to fuel reactions: shredded paper, sawdust, bread, rice, etc. Continue more with food.
- Cut all items into 1 to 3 inch pieces (3-8 cm). Shred paper. Smaller pieces break down faster.
- Add ¼ tablespoon of baking soda when adding food, for a total of 2-3 tsp per batch, to reduce acidity.
- Fill the reactor only half way to the top. Do not fill all the way to the lid - this could cause a jam.

STEP 3: CYCLING THE COMPOST

It is important to choose the best time to cycle. Wait until compost in the reactor looks **dark, well mixed**, no **individual items** are recognizable, and the reactor is **half full**. Then push the OK button to transfer compost to the red cure tray, where it continues to compost.

- Allow new items a minimum of 12-24 hours in the reactor. Cycle just before preparing a meal, or after a weekend away. If necessary, hold items overnight in a bowl to allow more time for the current batch.
- Allow as at least 3 days between cycles, but ideally 7-14 days. More time produces better compost. (Vacation mode cycles automatically after 20 days.)
- Some compost remains to “activate” the next batch. No more soil is required. Add brown items at the start of the new cycle to fuel compost reactions.

visit www.naturemill.com for more information

STEP 4: REMOVING FINISHED COMPOST

The FULL light will come on after several cycles. It may come on when you push the OK button to cycle.

- Remove the red cure tray and the drip tray from the machine when convenient. Deposit fresh compost outdoors to limit odors.
- Rinse the trays with a hose as needed.
- Reinsert trays right away, with the white drip tray at the far end, away from the side door. See drawing.
- Latch side door, push the OK button, and resume normal operation.

STEP 5: GARDENING WITH COMPOST

- See COMPOST QUALITY to assess compost results.
- Wash hands after handling. See PRECAUTIONS.
- Discard the liquid in the white drip tray, if any. Add this to plants, or to an existing compost pile.
- Fresh compost is ready for use outdoors, but is not fully “cured” or dried. For easier handling, or for indoor use, first cure and dry your compost:
- **OPTIONAL: Cure and dry outdoors** for several weeks or more, in a warm, breezy corner of your backyard. Just leave uncovered, so compost receives oxygen and dries out. You can even place directly on a compost pile. To cure on a roof or balcony, place on a tarp or wide tray, with drainage. Cold, freezing, rain, or snow will slow curing but will not destroy cultures.
- TIP: Use a hand trowel to break apart clumps for appearance. Remove any uncomposted items.
- **Fresh compost is very powerful. For gentle time-release, spread compost on soil surface only, like mulch.** Watering gradually draws nutrients into the soil. Turning the soil annually also mixes in nutrients.
- One batch of compost is enough for 10-40 sq ft (1-4 sq m), applied once or twice per year. Refer to individual plant instructions, if available.
- You can also mix 1 part *fully cured* compost with 10 to 20 parts soil. Full curing requires 4-6 months.
- TIP: make “compost tea” - see naturemill.com.

Copyright © 2006 NatureMill, Inc. All rights reserved.
Printed on recycled paper. PATENT PENDING 550-00003 rev A03

visit www.naturemill.com for more information

YES



ONE INCH
(2.5 CM)

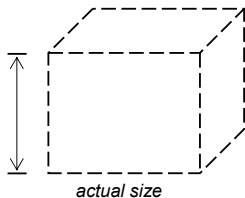

Cut items into 1 TO 3 INCH PIECES (3 - 8 CM).

Add a balance of BROWN and GREEN items:

BROWN ITEMS

bread, rice, pasta, grains
shredded paper*
sugar, cake, candy
nuts, nut shells, straw
corn cobs (cut), corn husks
laundry lint, cotton, wool
small yard leaves, dry flowers
sawdust, wood chips
-> from untreated, unpainted wood

GREEN ITEMS

fruit, vegetable scraps
-> limit acidic items to 1 lb (450 g) per load
meat, chicken, fish scraps
-> limit to 1 lb (450 g) per load
cheese, eggs, egg shells
coffee grounds, paper filters
tea leaves, tea bags
fish bones, shrimp tails
grass & plant clippings

Note: insufficient brown material may result in wet, heavy compost.

Note: jamming may result from paper wads, large items, or hard items.

- ➡ **Add 2 or 3 tablespoons of baking soda to each batch to reduce food acidity and odors – add more for highly acidic items.**
- ➡ **The compost should be slightly moist. If wet, add paper or sawdust. If dry, add fruits, lettuce, or 2 oz (60ml) hot water.**
- ➡ **When the compost is dark and well mixed, and reactor is half full, PUSH THE OK BUTTON. Cycling may be delayed up to 48 hours.**

PRECAUTION: Wash hands after handling compost. Keep lid and side door tightly closed, and power on, at all times. *Press the lid down if necessary.* Please read instruction manual.

CLEANING: Never use soaps or chemicals. DO NOT CLEAN THE INNER REACTOR. Wipe the hopper and the exterior with a damp paper towel. Clear debris from the door seal areas.

* Tear paper into shreds. A cross-cut paper shredder is ideal. Spread evenly across hopper to prevent wadding. Use uncoated paper only. Most color inks are non-toxic – contact publisher.

NO

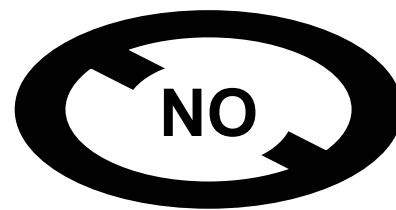

Do not fill reactor more than HALF WAY.

pourable liquids -> drip-dry items first
chemicals, soaps, salt, cosmetics, medicines
plastic, metal, glass, rubber, alcohol
hard items -> chicken or steak bones, fish heads, stale bread,
wine corks, lobsters & clams shells, avocado & peach pits, etc.
whole newspapers, magazines, books*
frozen or cold items -> bring to room temperature first
human or pet waste, diapers, hair
diseased or moldy foods, toothpicks, dental floss
limit acidic items to 1 lb (450 g) per load (acid kills cultures)
-> oranges, berries, grapes, plums, apples, pickles, tomatoes
-> 1 or 2 piece limit for lemon, lime, grapefruit, pineapple
limit strong-smelling items to 4 tbsp per load
-> garlic, onions, blue cheese, egg yolks, chili, curry, etc.
-> avoid raw garlic, onions, etc. if you are sensitive to odors

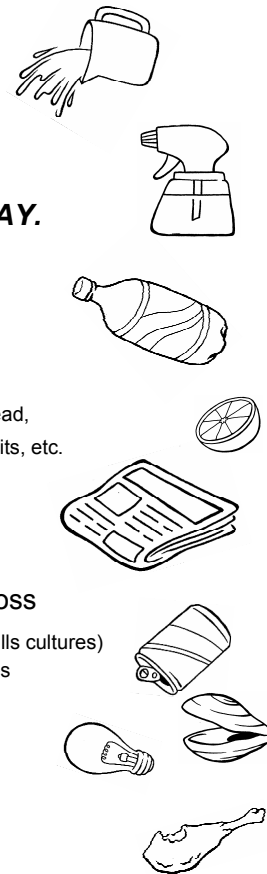

RETURN INSTRUCTIONS

If your unit has been *USED* (even a little), or requires repair, or is beyond the 30 day return period, or has been damaged during shipping:

Email us at service@naturemill.com with details about your issue. The customer service team will then determine the best way to repair or replace of your unit. Most issues can be resolved via email or shipping free replacement parts to you. A used unit generally *can not be shipped or returned* due to sanitary shipping restrictions.

To return an *UNUSED* unit, within the 30 DAY RETURN PERIOD:

Fill out this form and send it along with your unit to the address below. You must use the original packaging, and include all loose parts such as the power supply and drip tray. A credit will be made to your credit card if the unit has not been exposed to any food waste, there is no damage other than normal shipping wear, and all original components and packaging is included. We generally do not reimburse shipping expenses.

NatureMill/DAT Returns Dept.
N9246 Highway 80 South
Suite 2
Necedah, Wisconsin 54646

Name	_____	
Shipping address	_____	

Phone number	_____	ORDER ID: _____
Email address	_____	
Serial number	_____	
Reason for return	_____	

